

917 CONTI STREET
NEW ORLEANS, LA.

CERTIFIED CORRECT



REVISION HISTORY	
1	06/20/16
2	07/14/16
3	08/19/16
4	09/30/16

PROJECT#:	1435
PHASE:	PERMIT
DRAFTER:	Author
CHECKER:	Checker
SCALE:	AS NOTED
ISSUED:	09/30/2016

A601

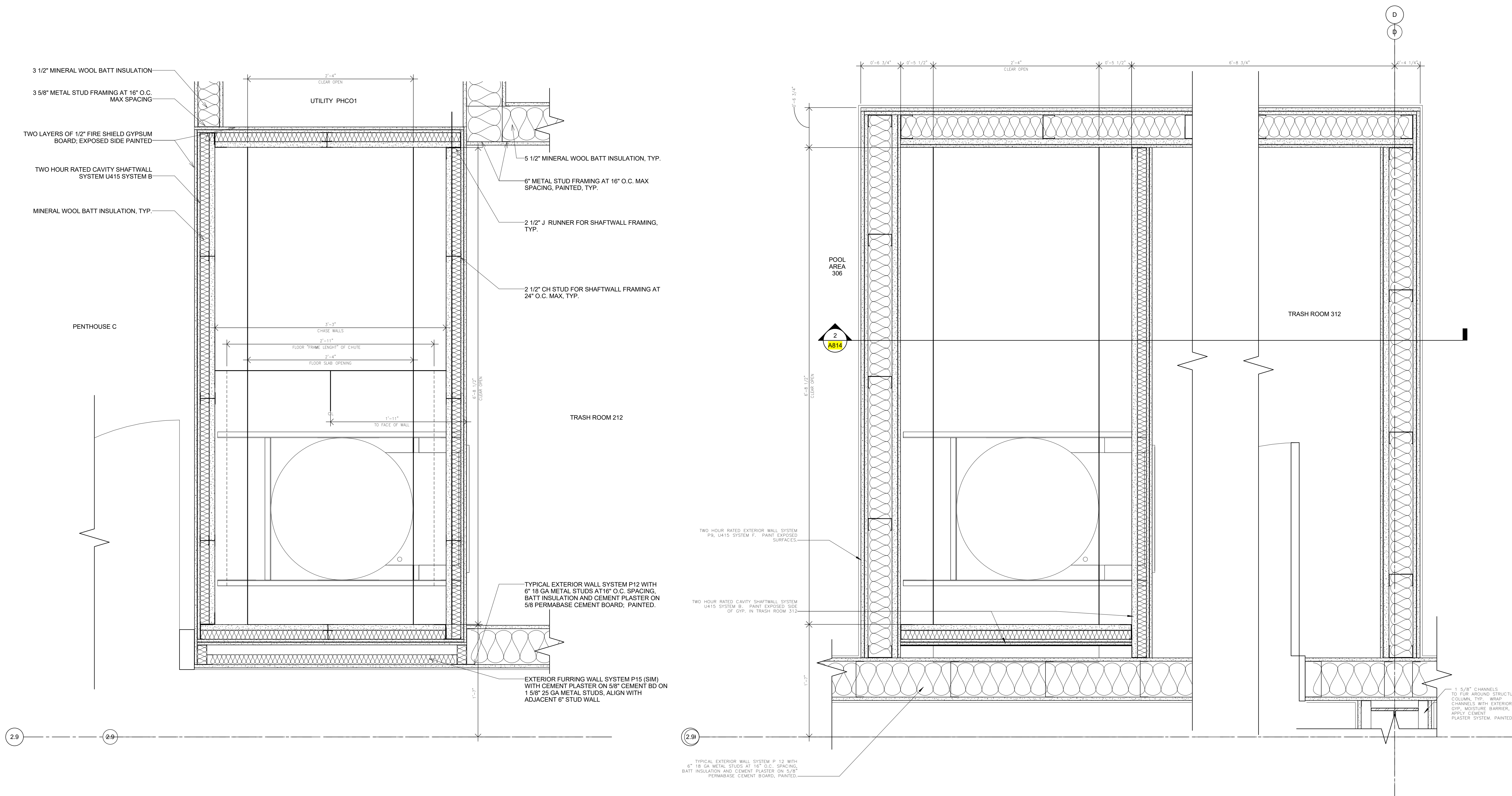

2 TWO HOUR RATED SHAFT AT TRASH CHUTE, THIRD FLOOR